

# Coromant Capto® naar Weldon / ISO 9766-adapter

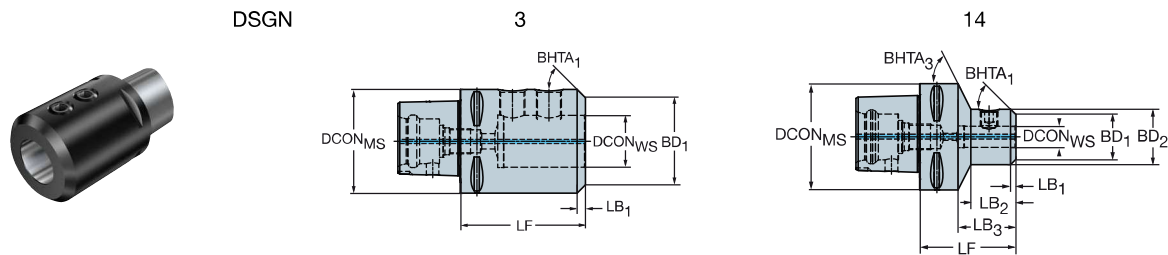

		Afmetingen, mm																				
CZC <sub>MS</sub>	CZC <sub>WS</sub>	CNSC	CXSC	DSGN	Bestelnummer	DCON <sub>MS</sub>	DCON <sub>WS</sub>	LF	LB <sub>1</sub>	LB <sub>2</sub>	LB <sub>3</sub>	LB <sub>4</sub>	BD <sub>1</sub>	BD <sub>2</sub>	BD <sub>3</sub>	BD <sub>4</sub>	BHTA <sub>1</sub>	BHTA <sub>3</sub>	BAR	NM	KG	RPMX
C10	20	3	1	14	C10-391.23-20 090	100,0	20,0	90,0	5,0	42,0	54,0	90,0	42,0	52,0	52,0	100,0	45°	63°	20	20,00	4,00	10000
	25	3	1	14	C10-391.23-25 105	100,0	25,0	105,0	8,0	61,0	69,0	105,0	49,0	65,0	65,0	100,0	45°	65°	20	25,00	5,09	10000
	32	3	1	14	C10-391.23-32 110	100,0	32,0	110,0	8,0	66,0	74,0	110,0	56,0	72,0	72,0	100,0	45°	60°	20	45,00	5,41	10000
	40	3	1	14	C10-391.23-40 115	100,0	40,0	115,0	8,0	76,0	79,0	115,0	74,0	90,0	90,0	100,0	45°	59°	20	45,00	6,58	10000
	50	3	1	3	C10-391.23-50 120	100,0	50,0	120,0	8,0	120,0			84,0	100,0				45°		20	60,00	7,20

# Coromant Capto® naar CoroMill® 327-adapter

Korte uitvoering, alleen voor segmentklemming

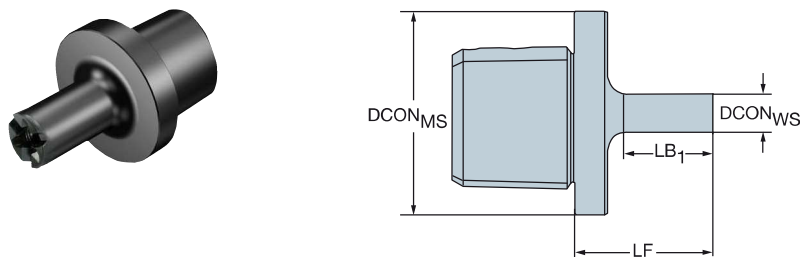

		Afmetingen, mm													
CZC <sub>MS</sub>	CZC <sub>WS</sub>	Bestelnummer	DCON <sub>MS</sub>	DCON <sub>WS</sub>	LF	LB <sub>1</sub>	NM	KG					RPMX		
C3	09	C3-391.327-09 035	32,0	9,0	35,0	22,0	4,30	0,14					55000		
C4	09	C4-391.327-09 035	40,0	9,0	35,0	22,0	4,30	0,21					39000		
		C4-391.327-12 043	40,0	12,0	43,0	30,0	6,50	0,29					39000		
C5	12	C5-391.327-12 043	50,0	12,0	43,0	30,0	6,50	0,41					28000		
		C5-391.327-14 048	50,0	14,3	48,0	35,0	6,50	0,43					28000		

Ga voor reserveonderdelen naar [www.sandvik.coromant.com](http://www.sandvik.coromant.com)



M1



N23



N15